

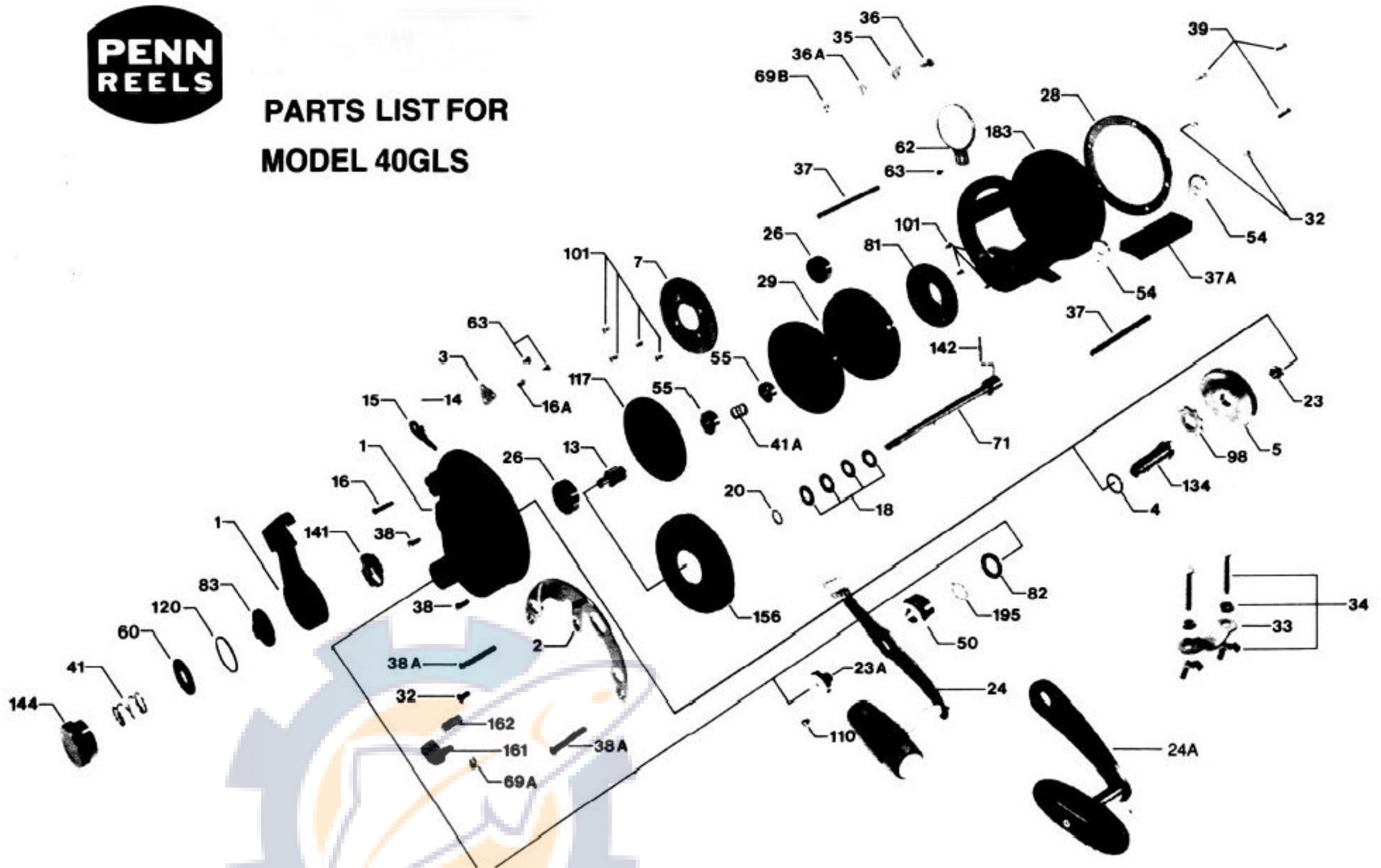

PARTS LIST FOR MODEL 40GLS



Penn Reel Parts list for:

Model: 40GLS

KEY PART NO.	NO.	DESCRIPTION	KEY PART NO.	NO.	DESCRIPTION
1	1-40	RIGHT SIDE PLATE	38A	38-40	R.S. POST SCREW (2)
2	2-40	QUADRANT RING	39	39-9	L.S. POST SCREW (3 REQ.)
3	3-40	BRIDGE RATCHET	41	41-40	PRE-SET KNOB SPRING
4	4-40	GEAR STUD WASHER	41A	41-109	BEARING SPRING
5	5-40	MAIN GEAR	50	50-50S	GEAR STUD COVER
7	7-40	METAL DRAG WASHER	54	54-113	HARNES LUG (2 REQ.)
13	13-40	PINION GEAR	55	55-6	R.S. SPOOL BALL BEARING (2)
14	14-40	DOG SPRING	60	60-40	LEVER BACKING WASHER
15	15-40	DOG	62	62-40	CLICK SPRING
16	16-9	TOP R.S. PLATE SCREW	63	63-500S	CLICK SPRING MTG. SCREW (1)
16A	63-349	BRIDGE SCREW	63A	63-500S	BRIDGE MTG. SCREW (2)
18	18-40	CLUTCH SPRING (4 REQ.)	69A	69B-50	STRIKE BUTTON RETAINING RING
20	20-40	THRUST WASHER	69B	69B-600	CLICK TONGUE RETAINING RING
21	21-245	CAM LEVER	71	71-40	SPOOL SPINDLE ASSEMBLY
23	23-6	GEAR MOUNTING SCREW	81	81-40	CLICK RATCHET
23A	23-114	HANDLE SCREW	82	82-40	HANDLE SHIM
24	24-40	COUNTERBALANCED HANDLE	83	83-245	PRE-SET COLLAR
24A	24-40P	POWER HANDLE	98	98-40	MAIN GEAR RATCHET
26	26-40	BALL BEARING (2)	101	101-30	DRIVE PLATE SCREW (4 REQ.)
28	28-40	L.S. RING	101A	101-30	CLICK RATCHET SCREW (4)
29	29L-40	SPOOL	110	110-60	HANDLE LOCK SCREW
32	110-50	R.S. QUADRANT SCREW (1)	117	117-40	DRIVE PLATE ASSEMBLY
32A	32-17	LEFT SIDE RING SCREW (2)	120	120-245	O'RING (not used with original cam lever#)
33	33-200	ROD CLAMP	134	134-40	GEAR STUD
33R	33R-200	RINGED ROD CLAMP	141	141-245	CAM FOLLOWER
34	34C-200	ROD CLAMP SCREW W/NUTS	142	142-40	SPINDLE FOLLOWER PIN
35	35-40	CLICK TONGUE	144	144-40	PRE-SET KNOB
36	36N-209	CLICK BUTTON	156	156-40	DRAG COVER
36A	36A-40	CLICK TONGUE WASHER	161	161-40	STRIKE BUTTON
37	37-40	FRAME POST (2 REQ.)	162	162-50	STRIKE BUTTON SPRING
37A	37A-40	TOP SPACER BAR	183	183-40	FRAME W/STAND
38	38-8	LOWER PLATE SCREW (2)	195	195-40	GEAR STUD RETAINING RING
			21-40 (old#)		
			83-40 (old#)		
			141-40 (old#)		